



Centric  
Centric  
Centric  
Centric

# Centric

Centric  
Centric  
Centric  
Centric  
Centric  
Centric

Centric

Centric

Centric

Centric

**C-H**

Centric

Centric

Centric

Centric

Centric

Centric

Centric

Centric

Centric

Centric

Centric

Centric

Centric

Centric

Centric

Centric

**Self-centering vice**  
hydraulically operated





## Self-centering vice, hydraulically operated

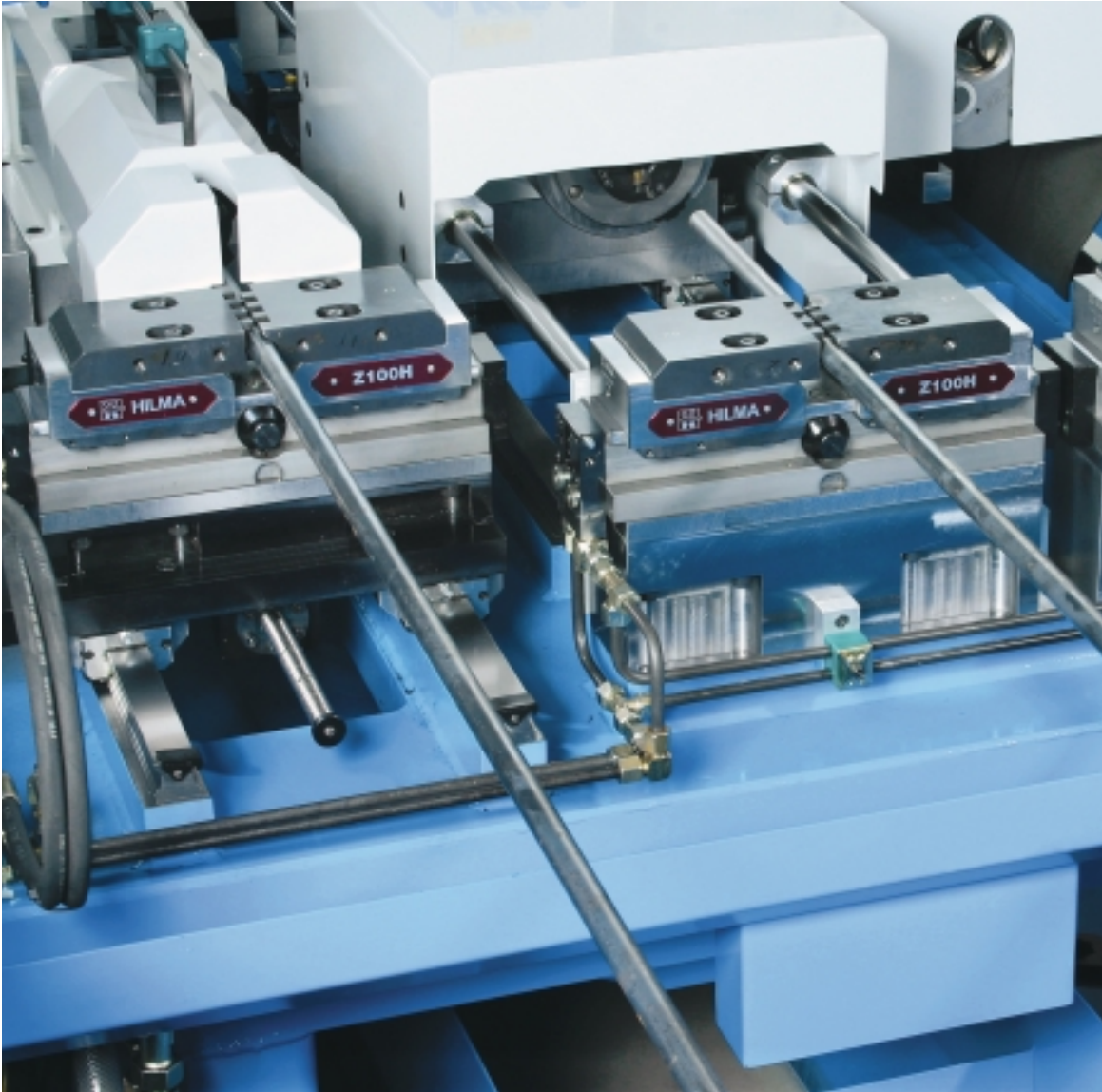

Self-centering vices position and clamp workpieces exactly on a defined symmetrical axis, taking account of their contours.

They may be used flexibly in machining centres, on machine tools and final processing machines as well in special jigs and fixtures.

Hydraulic clamping and unclamping is powered by an external pressure transmitter with a double-acting circuit.

The synchronising device which is adjustable without play ensures high centering precision.

- ◆ high clamping repeatability  $\pm 0,01$  mm
- ◆ constant length and large clamping ranges
- ◆ any mounting position
- ◆ possibilities for positioning and fastening customer-specific jaws
- ◆ protection against coolant and swarf by integral wiper in the clamping slides
- ◆ large stroke of the slide
- ◆ opening stroke limitation over set-screw
- ◆ suitable for connection at central lubrication with guiding ways oil VG 68 (Please ask for information)

## Self-centering vice HZ, hydraulically operated

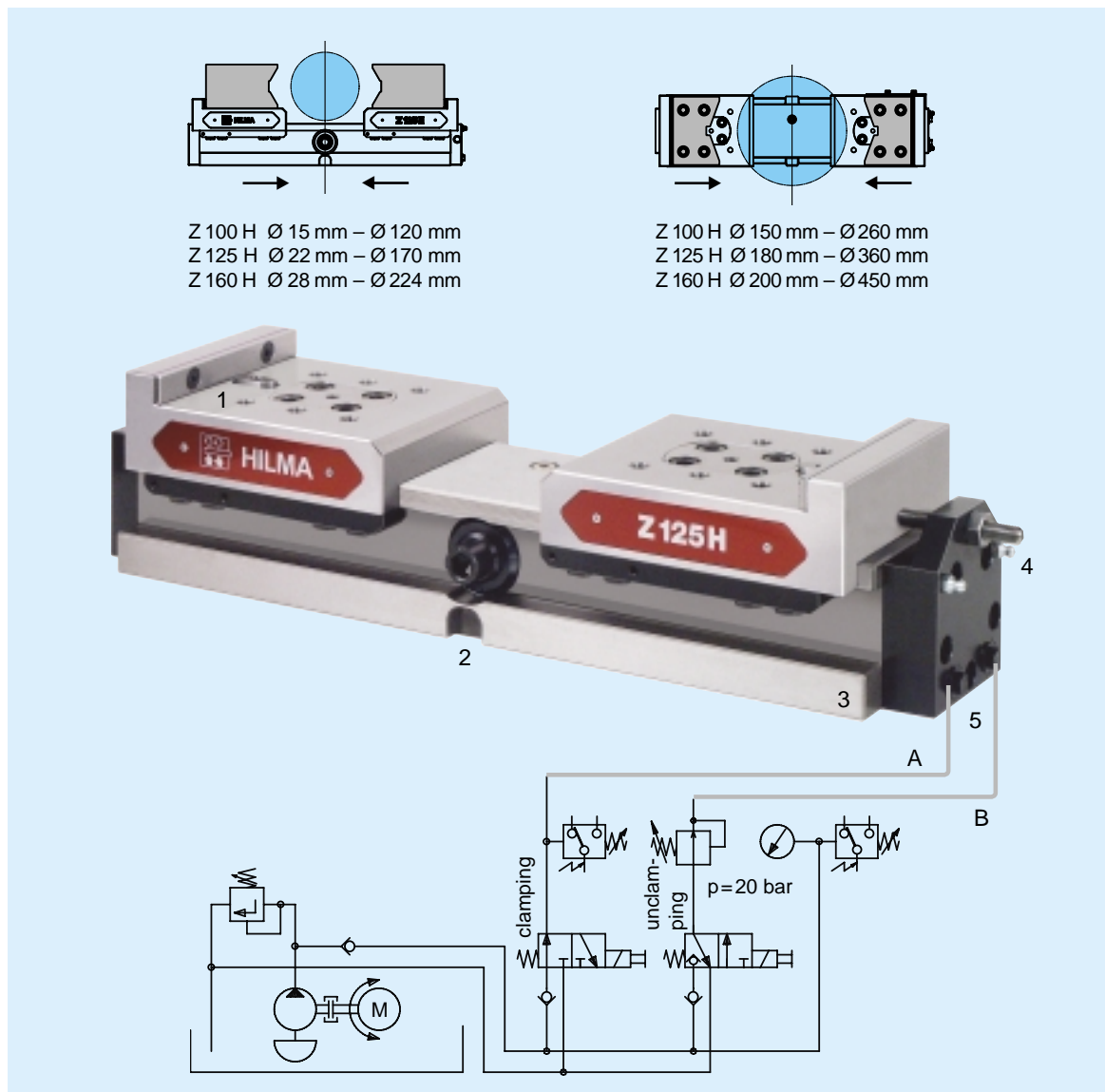

1. Fitting key, positioning and mounting holes for standard and special jaws
2. Keyway across the length for positioning
3. Clamping edge for claws
4. Lubrication nipples and connections, respectively, for central lubrication (use only guiding ways oil VG 68).
5. Oil ports G 1/4, A-clamping, B-unclamping

### Pressure transducer

For hydraulic oil supply, pump units working intermittently are preferred. Please ask for our detailed information about power units of the series 5 and 6.

### Use of vee jaws

For calculation of retention force  $F_H$  and holding torque  $M_H$  by use of vee jaws for pipe or shaft end machining we will provide our brochure 0.5000.1676.

## Technical data

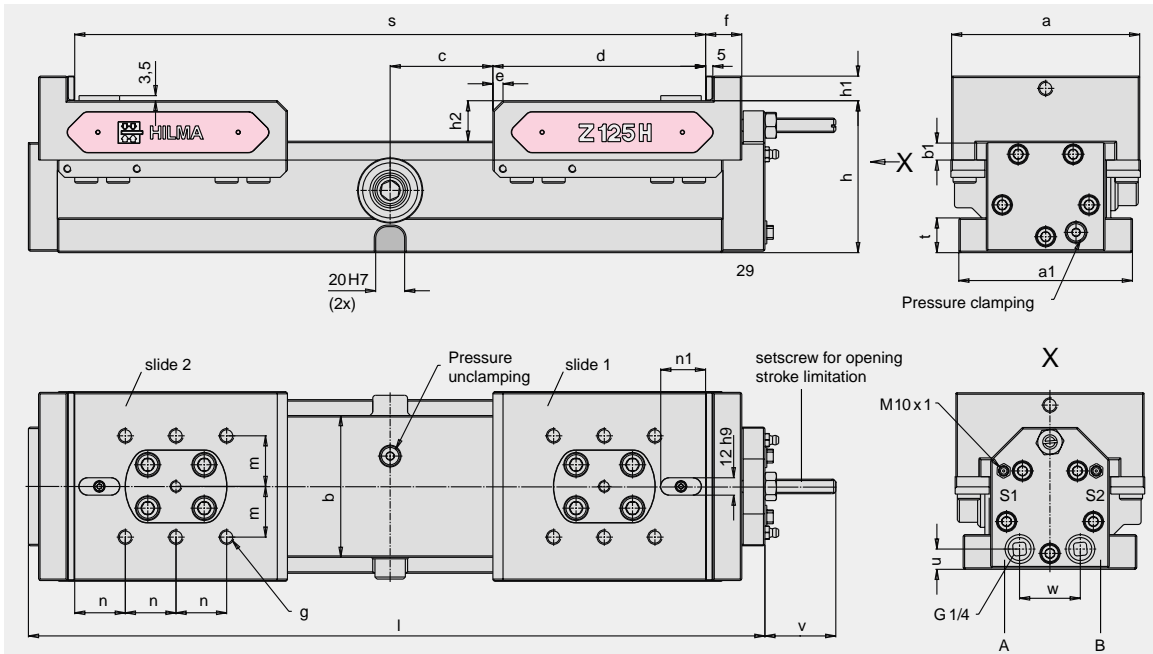

**Connections:** A-clamping, B-unclamping, S1-oil lubrication slide 1, S2-oil lubrication slide 2

Part no.	Type	Jaw width a	Clamping force Operating pressure		Unclamping pressure	Power stroke per slide	Oil consumption total stroke		Weight	
			kN	bar			clamping	unclamping		
9.3542.0101	9.3542.0201	Z 100 H	100	16	150	20	22	61	61	22
9.3543.0101	9.3543.0201	Z 125 H	130	25	150	20	35	138	138	39
9.3544.0101	9.3544.0201	Z 160 H	160	40	150	20	45	280	280	68

□ Design with opening stroke limitation over proximity switch on request.

Type	Dimensions in mm																			
	a	a1	b	b1	c	d	e	f	g	h	h1	h2	l	m	n	n1	s	u	v	w
Z 100 H	100	100	74	10	43	115	12	25	M 8x12	95	16	26	395	30	25	25	316	13	33	36
Z 125 H	130	120	98	13	71	147	7	25	M 10x15	105	17	28	509	35	35	32	436	14	49	42
Z 160 H	160	142	122	15	75	185	22	30	M 12x18	125	20	34	605	40	50	32	520	16	60	46

### Free space for a customized fastening drilling template

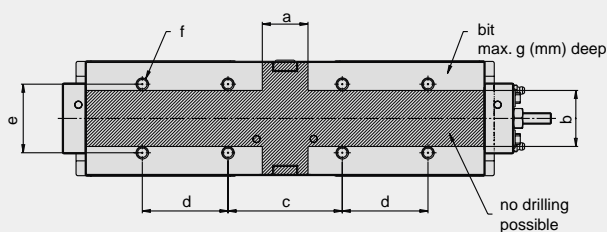

Type	a	b	c	d	e	available thread f	g
Z 100 H	40	49	100	75	60	M10 x 15	20
Z 125 H	45	55	164	83	68	M12 x 20	22
Z 160 H	55	60	160	120	80	M12 x 20	22

Set of tenon blocks  
DIN 6323

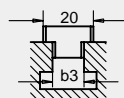

1 set = 2 blocks  
**Part no. 9.3917.4121**  
**Part no. 9.3917.4141**

Slot in machine bed 14h6 (b3)  
Slot in machine bed 18h6 (b3)

Set of clamping claws  
with screws  
M 12x45

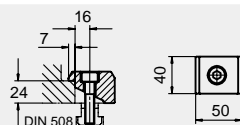

For safe clamping on the machine bed  
1 set = 4 claws  
**Part no. 9.3777.2011**

Subject to change without notice. Printed in Germany