

**NC-M Hydraulic machine vice mechanical-hydraulic**

The completely revised power transmission system requires minimum effort on the crank handle. An angular drive (optional extra) makes actuation easier, e.g. in the case of longitudinal clamping on the machine platen.

The optional selection of clamping force (retrofitting possible) enables the clamping force to be applied in six stages up to the maximum.

QIS jaws with a downthrust effect (optional extra)

Guideways hardened and ground

Resistant to deformation thanks to the optimised cross section of the base



**For tool making, mould making, construction of jigs and fixtures and production**

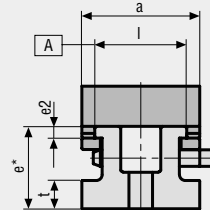
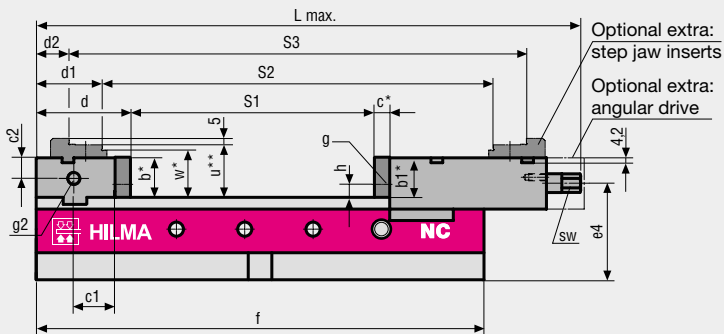

Standard reversible jaws plain/serrated, crank handle, operating manual

\*Tolerance  $\pm 0,01$  mm  
\*\*Tolerance  $\pm 0,02$  mm

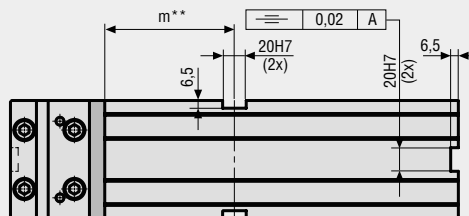
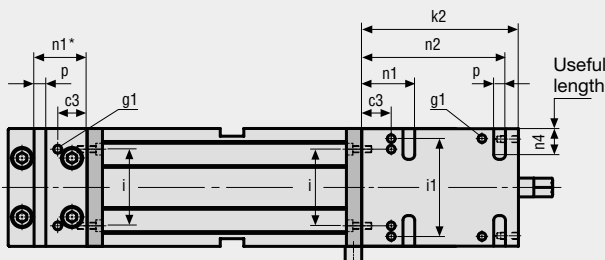

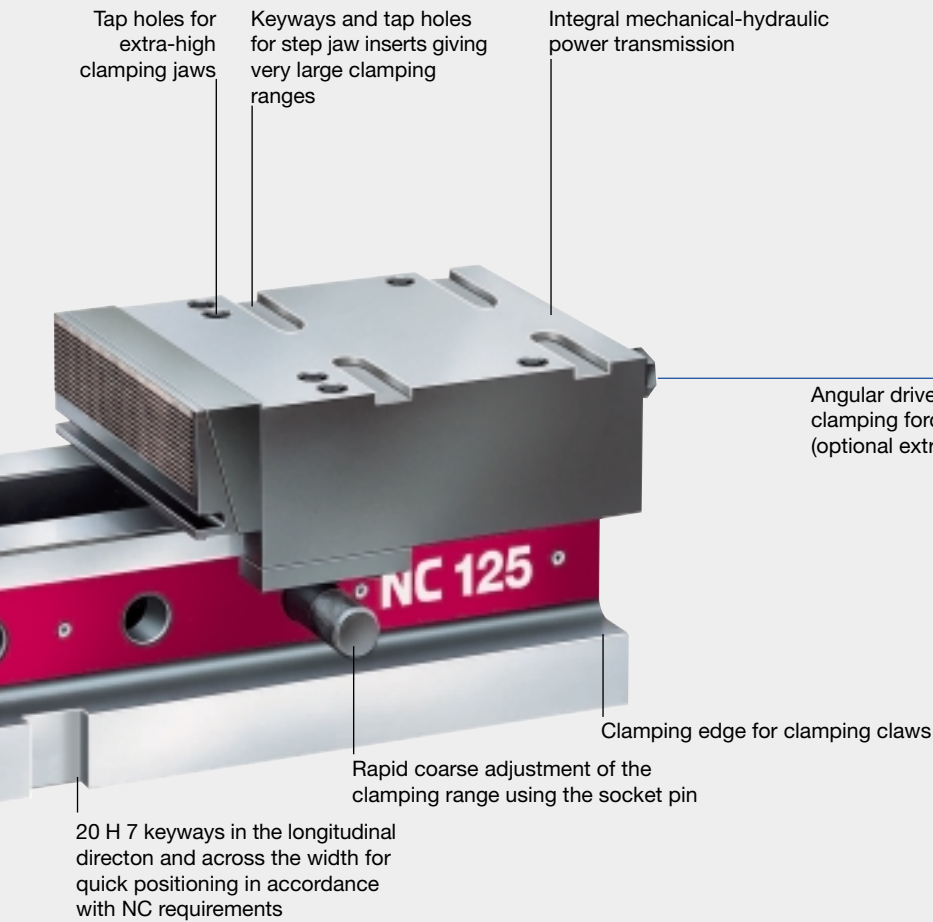

Recommended accessories:

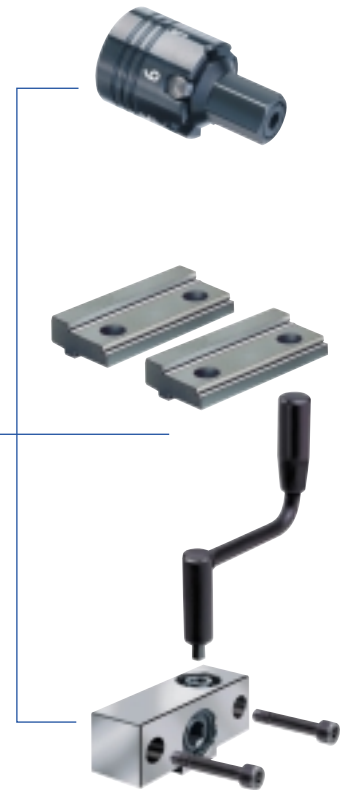

Angular drive, 6-stage selection of clamping force and step jaw inserts (optional extra)



Type	Part no.	Jaw width a mm	Clamping force		Effort on the crank handle/crank radius			Clamping width			Overall length L max. mm	Weight kg
			kN	N	mm	S1 mm	S2 mm	S3 mm				
<b>NC100M</b>	<b>9.3072.0203</b>	100	25	50	80	205	330	386	464	18,5		
<b>NC125M</b>	<b>9.3073.0203</b>	125	40	75	100	225	363	431	526	31,5		
<b>NC160M</b>	<b>9.3074.0203</b>	160	50	95	125	309	503	573	684	58,5		

Type	Dimensions in mm																													
	b	b1	c	c1	c2	c3	d	d1	d2	e	e2	e4	f	g	g1	g2	h	i	i1	k2	l	m	n1	n2	n4	p	sw	t	u	w
<b>NC100M</b>	34	33,5	13	35	17,5	25	80	56	28	70	10	82	380	M6 x 8	M8 x 12	M12 x 18	11	65	83	133	78g6	110	45	122	22	10H7	14	24	45	40
<b>NC125M</b>	45	44	15	36	23	30	100	69	35	82	13	98	430	M8 x 10	M10 x 13	M12 x 18	14	80	104	147	98g6	115	56	132	31	12H7	17	27	58	53
<b>NC160M</b>	54	53	18	50	27	45	120	72	37	95	15	115	550	M10 x 11	M12 x 16	M20 x 27	17	100	130	189	125g6	155	73	171	37	18H7	19	27	70	65

Jaws and accessories see pages 23 - 27.