

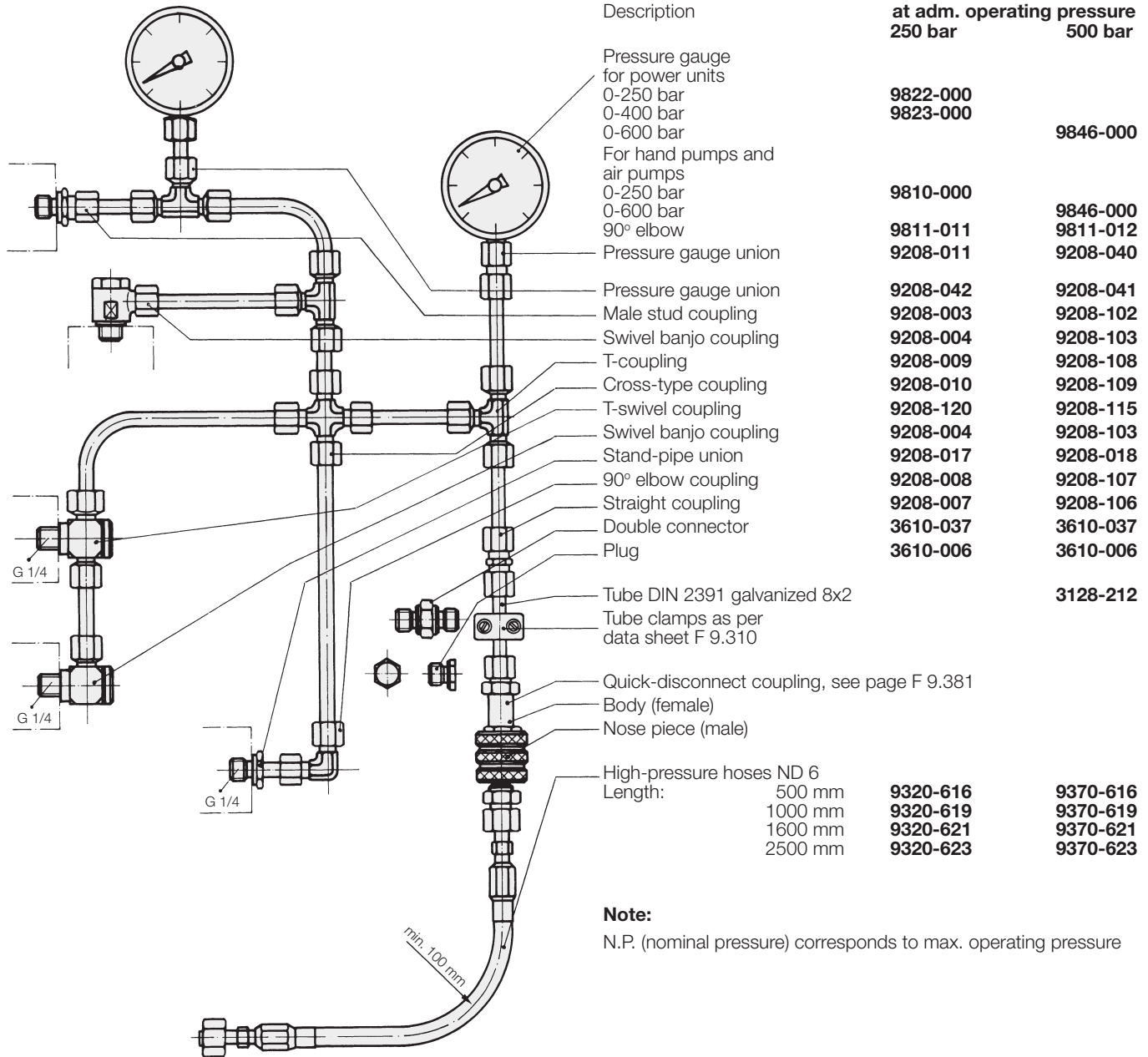





**Fittings, Cutting ring unions as per DIN 2353,  
Hydraulic oil, seamless precision steel tubes,  
pressure gauges**

**Application example**





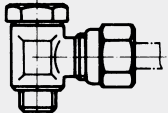

Cutting ring unions		N.P.	Part-no.
Nut, type L		(bar)	
	m 6 L for tube Ø 6	250	<b>9206-001</b>
	m 8 L for tube Ø 8	250	<b>9208-001</b>
	m 10 L for tube Ø 10	250	<b>9210-002</b>
	m 15 L for tube Ø 15	250	<b>9215-001</b>
Nut, type S			
	m 8 S for tube Ø 8	500	<b>9208-100</b>
	m 10 S for tube Ø 10	500	<b>9210-102</b>
	m 14 S for tube Ø 14	500	<b>9214-001</b>
	m 16 S for tube Ø 16	400	<b>9216-002</b>
Cutting ring, type L			
	s 6 L for tube Ø 6	250	<b>9206-002</b>
	s 8 L for tube Ø 8	250	<b>9208-101</b>
	s 10 L for tube Ø 10	250	<b>9210-103</b>
	s 15 L for tube Ø 15	250	<b>9215-002</b>
Cutting ring, type S			
	s 8 S for tube Ø 8	500	<b>9208-101</b>
	s 10 S for tube Ø 10	500	<b>9210-103</b>
	s 14 S for tube Ø 14	500	<b>9214-002</b>
	s 16 S for tube Ø 16	400	<b>9216-003</b>

Tube male stud coupling			
Type L			
	D 6 L for tube Ø 6	G 1/8	250 <b>9206-003</b>
	D 8 L for tube Ø 8	G 1/8	250 <b>9208-034</b>
	D 8 L for tube Ø 8	G 1/4	250 <b>9208-003</b>
	D 10 L for tube Ø 10	G 1/4	250 <b>9210-004</b>
	D 15 L for tube Ø 15	G 1/2	250 <b>9215-003</b>
Type S			
	D 8 S for tube Ø 8	G 1/8	500 <b>9208-116</b>
	D 8 S for tube Ø 8	G 1/4	500 <b>9208-102</b>
	D 10 S for tube Ø 10	G 3/8	500 <b>9210-104</b>
	D 14 S for tube Ø 14	G 1/2	500 <b>9214-003</b>
	D 16 S for tube Ø 16	G 1/2	400 <b>9216-004</b>

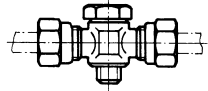
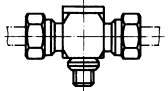
Swivel banjo coupling			
Type L			
	SVH 6 LR for tube Ø 6	G 1/8	250 <b>9206-004</b>
	SVH 8 LR for tube Ø 8	G 1/4	250 <b>9208-004</b>
	SVH 10 LR for tube Ø 10	G 1/4	250 <b>9210-015</b>
	SVH 15 LR for tube Ø 15	G 1/2	250 <b>9215-004</b>
Type S			
	SVH 8 SR/SA tube Ø 8	G 1/4	500 <b>9208-103</b>
	SVH 10 SR for tube Ø 10	G 3/8	400 <b>9210-105</b>
	SVH 14 SR for tube Ø 14	G 1/2	500 <b>9214-016</b>
	SVH 16 SR for tube Ø 16	G 1/2	400 <b>9216-005</b>

T-swivel coupling, without throttling			
Type L			
	DSVQ 6 LR for tube Ø 6	G 1/8	250 <b>9206-019</b>
	DSVQ 8 LR for tube Ø 8	G 1/4	250 <b>9208-120</b>
	DSVQ 10 LR for tube Ø 10	G 1/4	250 <b>9210-023</b>
	DSVQ 15 LR for tube Ø 15	G 1/2	250 <b>9215-030</b>
Type S			
	DSVQ 8 SR/SA tube Ø 8	G 1/4	500 <b>9208-115</b>
	DSVT 10 SR for tube Ø 10	G 3/8	400 <b>9210-107</b>
	DSVT 16 SR for tube Ø 16	G 1/2	400 <b>9216-007</b>

Straight coupling			
Type L			
	E 6 L for tube Ø 6		250 <b>9206-007</b>
	E 8 L for tube Ø 8		250 <b>9208-007</b>
	E 10 L for tube Ø 10		250 <b>9210-007</b>
	E 15 L for tube Ø 15		250 <b>9215-007</b>
Type S			
	E 8 S for tube Ø 8	500	<b>9208-106</b>
	E 10 S for tube Ø 10	500	<b>9210-108</b>
	E 16 S for tube Ø 16	400	<b>9216-008</b>

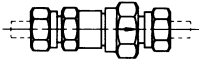
Check valve, poppet type			
Type L			
	RWD 6 L for tube Ø 6	250	<b>9206-012</b>
	RWD 8 L for tube Ø 8	250	<b>9208-012</b>
	RWD 10 L for tube Ø 10	250	<b>9210-012</b>
	RWD 15 L for tube Ø 15	250	<b>9215-011</b>
Type S			
	RWD 8 S for tube Ø 8	500	<b>9208-111</b>
	RWD 10 S for tube Ø 10	500	<b>9210-116</b>
	RWD 14 S for tube Ø 14	500	<b>9214-011</b>
	RWD 16 S for tube Ø 16	400	<b>9216-012</b>

Blanking plugs for cutting ring unions			
	VB 6 S for tube Ø 6		<b>9206-023</b>
	VB 8 S for tube Ø 8		<b>9208-039</b>
	VB 10 S for tube Ø 10		<b>9210-024</b>
	VB 14 S for tube Ø 14		<b>9214-012</b>
	VB 15 L for tube Ø 15		<b>9215-031</b>
	VB 16 S for tube Ø 16		<b>9216-016</b>

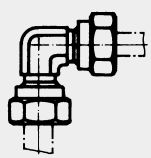
90° elbow coupling		N.P.	Part-no.
Type L		(bar)	
	K 6 L for tube Ø 6	250	<b>9206-008</b>
	K 8 L for tube Ø 8	250	<b>9208-008</b>
	K 10 L for tube Ø 10	250	<b>9210-008</b>
	K 15 L for tube Ø 15	250	<b>9215-008</b>
	KE 8 L for tube Ø 8	250	<b>9208-038</b>
Type S			
	K 8 S for tube Ø 8	500	<b>9208-107</b>
	K 10 S for tube Ø 10	500	<b>9210-112</b>
	K 14 S for tube Ø 14	500	<b>9214-008</b>
	K 16 S for tube Ø 16	400	<b>9216-009</b>
	KE 8 S for tube Ø 8	500	<b>9208-036</b>

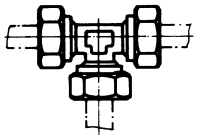
T-coupling			
Type L			
	Q 6 L for tube Ø 6	250	<b>9206-009</b>
	Q 8 L for tube Ø 8	250	<b>9208-009</b>
	Q 10 L for tube Ø 10	250	<b>9210-009</b>
	Q 15 L for tube Ø 15	250	<b>9215-009</b>
Type S			
	Q 8 S for tube Ø 8	500	<b>9208-108</b>
	Q 10 S for tube Ø 10	500	<b>9210-113</b>
	Q 14 S for tube Ø 14	500	<b>9214-009</b>
	Q 16 S for tube Ø 16	400	<b>9216-010</b>

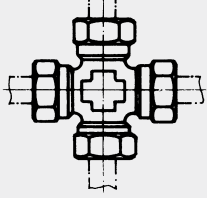
Cross-type coupling			
Type L			
	KV 6 L for tube Ø 6	250	<b>9206-011</b>
	KV 8 L for tube Ø 8	250	<b>9208-010</b>
	KV 10 L for tube Ø 10	250	<b>9210-010</b>
	KV 15 L for tube Ø 15	250	<b>9215-010</b>
Type S			
	KV 8 S for tube Ø 8	500	<b>9208-109</b>
	KV 10 S for tube Ø 10	500	<b>9210-114</b>
	KV 16 S for tube Ø 16	400	<b>9216-011</b>

Thread reducing adaptor			
	Outer thread	Inner thread	
	G 1/2	G 1/4	<b>3613-015</b>
	G 3/8	G 1/4	<b>3613-016</b>
	G 1/2	G 3/8	<b>3613-018</b>

Plug with knife-edge sealing			
	Thread G 1/4	500	<b>3610-006</b>
	Thread G 1/2	500	<b>3610-000</b>

Straight tube male stud coupling sealing with elastic seal to seal hardened surfaces			
Type L			
	D 6 L ED for tube Ø 6	G 1/8	250 <b>9206-028</b>
	D 8 L ED for tube Ø 8	G 1/4	250 <b>9208-131</b>
	D 10 L ED for tube Ø 10	G 1/4	250 <b>9210-028</b>
	D 15 L ED for tube Ø 15	G 1/2	250 <b>9215-033</b>
Type S			
	D 8 S ED for tube Ø 8	G 1/4	500 <b>9208-132</b>
	D 10 S ED for tube Ø 10	G 3/8	500 <b>9210-029</b>
	D 14 S ED for tube Ø 14	G 1/2	500 <b>9214-018</b>
	D 16 S ED for tube Ø 16	G 1/2	400 <b>9216-021</b>

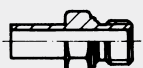
Stand pipe union			
Type L up to 250 bar			
	DC 8 L for tube Ø 8	G 1/4	<b>9208-017</b>
	DC 10 L for tube Ø 10	G 1/4	<b>9210-109</b>
Type S up to 500 bar			
	DC 8 S for tube Ø 8	G 1/4	<b>9208-018</b>

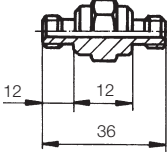
Double connector G 1/4 for tube Ø 8			
		500	<b>3610-037</b>

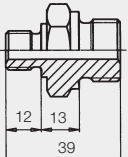
Double connector G 1/4 - G 1/2			
		500	<b>3610-062</b>



### Straight bulk head fittings



	Diam. of the mounting hole	N.P. [bar]	Part-no.
<b>Type L</b>			
R 6 L for tube Ø 6	13 mm	250	<b>9206-026</b>
R 8 L for tube Ø 8	15 mm	250	<b>9208-023</b>
R 10 L for tube Ø 10	17 mm	250	<b>9210-117</b>
R 15 L for tube Ø 15	23 mm	250	<b>9215-022</b>
<b>Type S</b>			
R 8 S for tube Ø 8	17 mm	500	<b>9208-117</b>
R 10 S for tube Ø 10	19 mm	500	<b>9210-119</b>
R 14 S for tube Ø 14	23 mm	500	<b>9214-022</b>
R 16 S for tube Ø 16	25 mm	400	<b>9216-017</b>

### 90°-elbow bulk head fitting

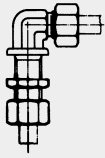

	Diam. of the mounting hole	N.P. [bar]	Part-no.
<b>Type L</b>			
U 6 L for tube Ø 6	13 mm	250	<b>9206-014</b>
U 8 L for tube Ø 8	15 mm	250	<b>9208-029</b>
U 10 L for tube Ø 10	17 mm	250	<b>9210-110</b>
U 15 L for tube Ø 15	23 mm	250	<b>9215-018</b>
<b>Type S</b>			
U 8 S for tube Ø 8	17 mm	500	<b>9208-118</b>
U 10 S for tube Ø 10	19 mm	500	<b>9210-027</b>
U 14 S for tube Ø 14	23 mm	500	<b>9214-017</b>
U 16 S for tube Ø 16	25 mm	400	<b>9216-020</b>

### Hydraulic oil in containers

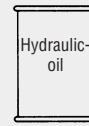

Hydraulic oil in containers	Part-no.
HLP 22 V = 1 litre	<b>9892-001</b>
5 litre	<b>9893-001</b>
20 litre	<b>9894-001</b>
HLP 32 V = 1 litre	<b>9895-001</b>
5 litre	<b>9891-001</b>
20 litre	<b>9899-001</b>
HLP 46 V = 1 litre	<b>9896-001</b>
5 litre	<b>9897-001</b>
20 litre	<b>9898-001</b>

### Fire-resistant hydraulic oil Oemeta HF-Du

1 litre	<b>9892-002</b>
5 litre	<b>9893-002</b>
20 litre	<b>9894-002</b>

### Precision steel tube, ST 37 DIN 2391 galvanized



	N.P. [bar]	Part-no.
8 x 1	250	<b>3128-112</b>
8 x 1,5	400	<b>3128-113</b>
8 x 2	500	<b>3128-212</b>
10 x 1	250	<b>3128-114</b>
15 x 1,5	250	<b>3128-119</b>

### Connecting insert for plates and manifolds, 500 bar, ND 5

Short version for connections, without space

Installation example

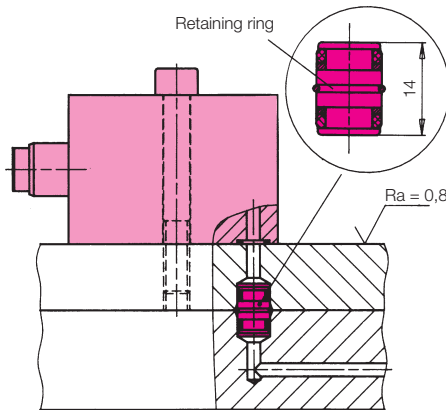

Length	Max. operating pressure	Seals	Part-no.
14 mm	500 bar	VITON®	<b>9210-132</b>

### Installation dimensions short version

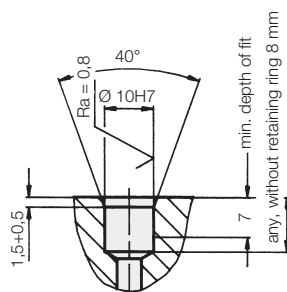

**Note:** max. mismatch of bore holes: short version 0.05 mm

### Long version

for connections with space up to 5 mm

Installation example

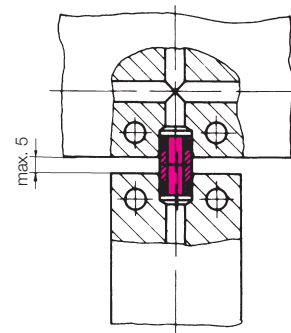

Length	Max. operating pressure	Seals	Part-no.
19 mm	500 bar	VITON®	<b>9210-127</b>

### Installation dimensions long version

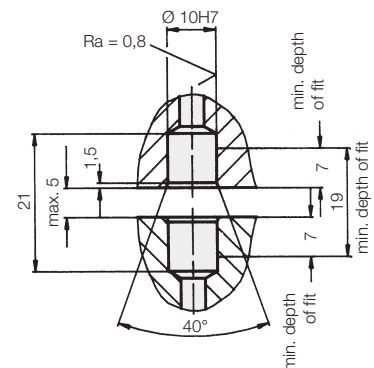

**Note:** max. mismatch of bore holes: long version 0.1 mm



Pressure gauge

### Important note

Pressure gauges with plug must not be used in coolant jets. In such applications the pressure gauge with screw plug or closed housing are to be used.

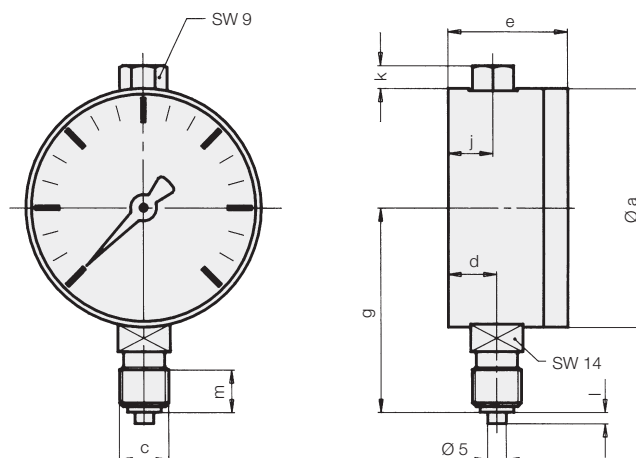

Pressure gauge with glycerin filling and plug

Measuring range	Ø a	c	d	e	g±1	j	k	l	m	Part-no.
0- 40 bar	63	G1/4	13	32	54	12	-	3	12	<b>9820-000</b>
0-100 bar	63	G1/4	13	32	54	12	-	3	12	<b>9821-000</b>
0-250 bar without glycerin filling	63	G1/4	13	32	54	-	-	3	12	<b>9810-000</b>
0-250 bar	63	G1/4	13	32	54	12	-	3	12	<b>9822-000</b>
0-400 bar	63	G1/4	13	32	54	12	-	3	12	<b>9823-000</b>



Pressure gauge with screw plug

Pressure gauge with glycerin filling and screw plug, wrench size SW 9 or closed housing

Measuring range	Ø a	c	d	e	g±1	j	k	l	m	Part-no.
0-250 bar	63	G1/4	17.5	42	53	16	5	3	12	<b>9822-005</b>
0-400 bar	63	G1/4	17.5	42	53	16	5	3	12	<b>9823-005</b>
0-600 bar	63	G1/4	17.5	42	53	16	5	3	12	<b>9846-000</b>

Pressure gauge union

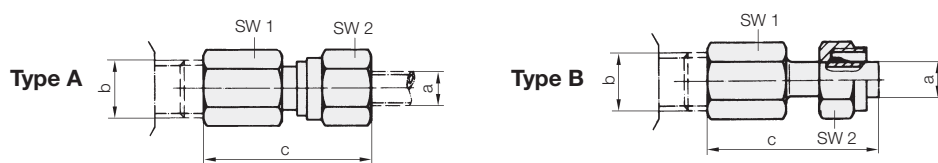

Type	Fitting	a	b	c	SW1	SW2	Part-no.
A	0-250 bar	8	G1/4	37	17	17	<b>9208-011</b>
B	0-250 bar	8	G1/4	40	19	17	<b>9208-042</b>
A	0-500 bar	8	G1/4	42	19	19	<b>9208-040</b>
B	0-500 bar	8	G1/4	40	19	19	<b>9208-041</b>
A	0-500 bar	8	G1/2	41	27	19	<b>9208-110</b>

90°-elbow

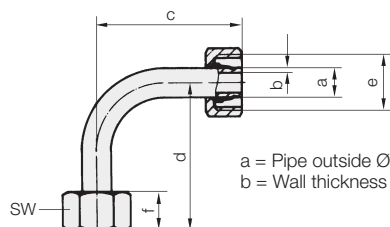

a = Pipe outside Ø  
b = Wall thickness

90°-elbow	a	b	c	d	e	f	SW	Part-no.
0-250 bar	8	1	48	48	M14 x 1.5	15	17	<b>9811-011</b>
0-500 bar	8	1.5	48	76	M16 x 1.5	16	19	<b>9811-012</b>